



Ultrasurgery Tip Book

Surgery-X Woodpecker

Mectron



Bone surgery

Dimensions Unit: mm

Model

Page

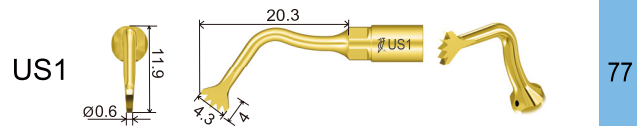

77

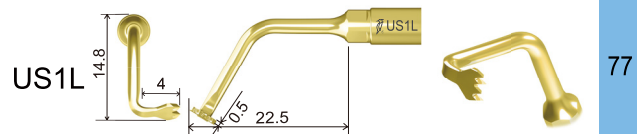

77

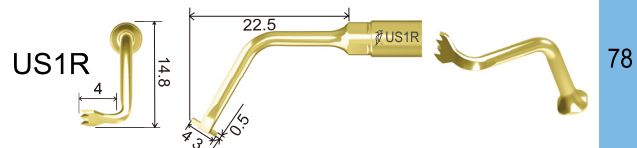

78

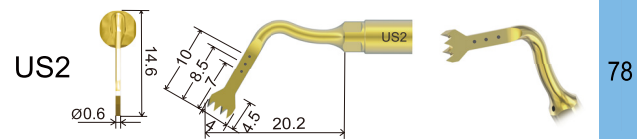

78

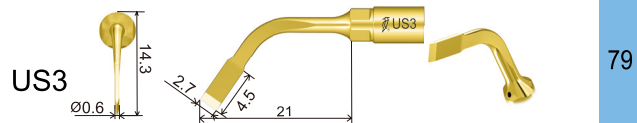

79

Bone surgery

Model		Page
US4		79
US5		80
US6		80
US13		81
US21		81
US25		82

Sinus lifting

Dimensions Unit: mm

Model		Page
UL1		82
UL2		83
UL3		83
UL4		84
UL5		84

Sinus lifting

Model	Page
<p>UL6</p>	85
<p>UL7</p>	85
<p>UL8</p>	86

Endodontics

<p>UE1</p>	86
------------	----

Endodontics

Dimensions Unit: mm

Model	Page
<p>UE2</p>	87
<p>UE3</p>	87
<p>UE4</p>	88

Exelcymosis

<p>UC1</p>	88
<p>UC2</p>	89

Exelcymosis

Model	Page
<p>UC3</p>	89
<p>UC5</p>	90
<p>UC6</p>	90
<p>UC7</p>	91
<p>UC8</p>	91

Implantaion

Dimensions Unit: mm

Model	Page
<p>UI1</p>	92
<p>UI2</p>	92
<p>UI3</p>	93
<p>UI4</p>	93
<p>UI5</p>	94

Implantaion

Model	Image	Page
UI6		94
UI7		95
UI8		95
UI9		96

Periodontal surgery

Dimensions Unit: mm

Model	Image	Page
UP1		96
UP2		97
UP3		97
UP4		98
UP5		98

Periodontal surgery

Dimensions Unit: mm

Model Page

UP6

15.2
17.6
11.5
1.1
1.9
UP6

99

UP7

11.2
22.3
10
0.6
1.5
UP7

99

Ultrasonic scaler Tip

MODE : X

POWER

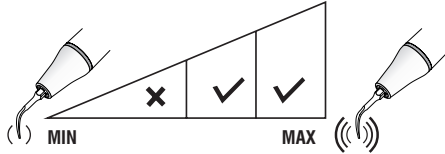

Meaning of the above symbols:

Mode X indicates that the tip should be used in X mode of the scaler.

Power

The first grid indicates that the power is 0-30% of the power in the X mode of the scaler.

The second grid indicates that the power is 30% -60% of the power in the X mode of the scaler.

The third grid indicates that the power is 60% -100% of the power in the X mode of the scaler.

Meaning of the above symbols:

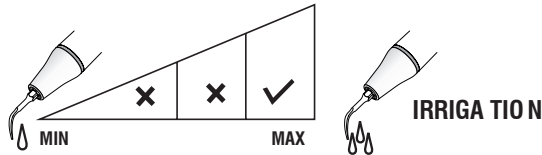

Water volume

The first grid indicates that the water volume is 0-30%.

The second grid indicates that the water volume is 30% -60%.

The third grid indicates that the water volume is 60% -100%.

Ultrasonography Tip

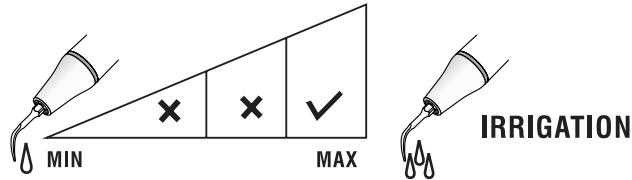

Meaning of the above symbols:

Water volume

The first grid indicates that the water volume is 0-30%.

The second grid indicates that the water volume is 30% -60%.

The third grid indicates that the water volume is 60% -100%.

US1

High effectiveness osteotomy of large bone sections during maxillofacial surgery, it can also be used for exodontia exodontics.

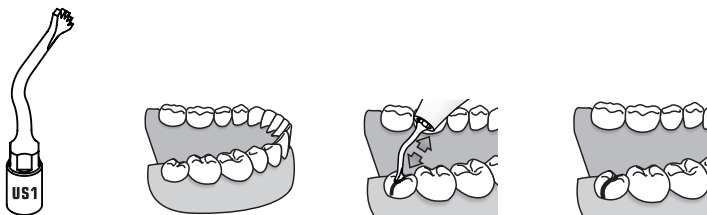

US1L

Left angle 90°, horizontal osteotomy technique in maxilla and mandible

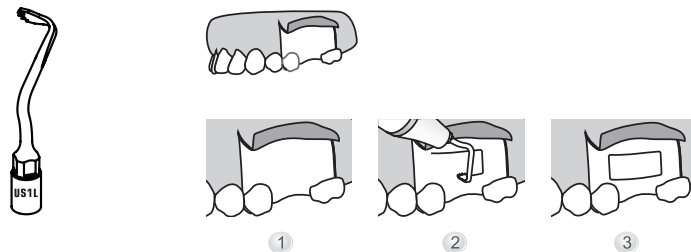

MODE: BONE

POWER:

Quality 1, Quality 2, Quality 3
(Cortical/Spongious)

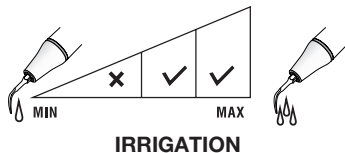

MODE: BONE

POWER:

Quality 1, Quality 2, Quality 3
(Cortical/Spongious)

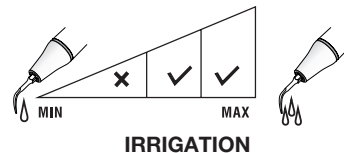

US1R

Right angle 90°, horizontal osteotomy technique in maxilla and mandible.

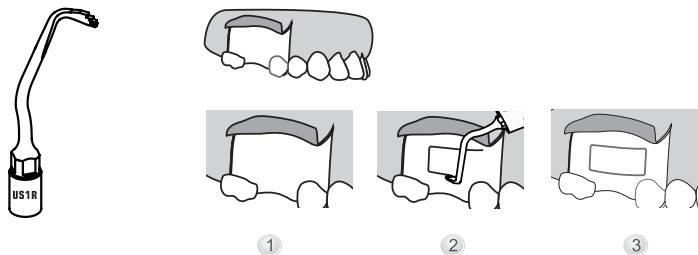

MODE: BONE

POWER:

Quality 1, Quality 2, Quality 3
(Cortical/Spongius)

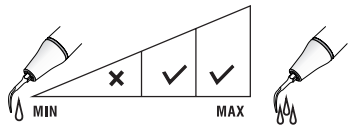

IRRIGATION

US2

High effectiveness osteotomy technique in maxilla and mandible(ridge expansion, corticotomy technique, bone block grafting).

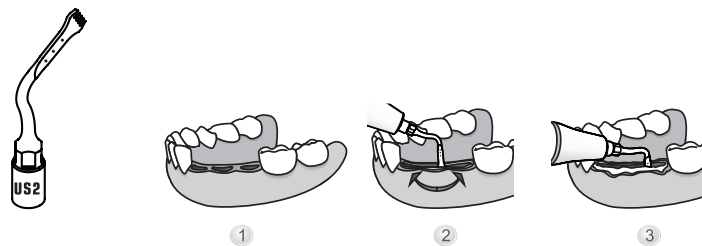

MODE: BONE

POWER:

Quality 1, Quality 2, Quality 3
(Cortical/Spongius)

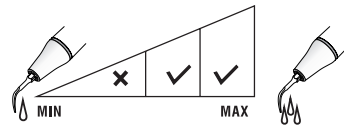

IRRIGATION

US3

Osteotomy: osteotome of great precision in anatomically thin structures.

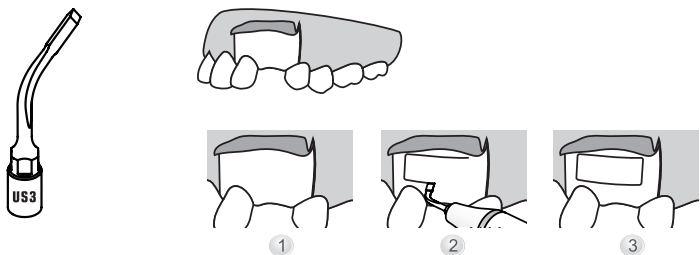

MODE: BONE

POWER:

Quality 1, Quality 2, Quality 3
(Cortical/Spongious)

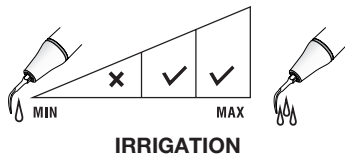

US4

Universal osteoplasty: periodontal osteotomy, bone chips harvesting, inflammatory tissue removal (cyst, etc.).

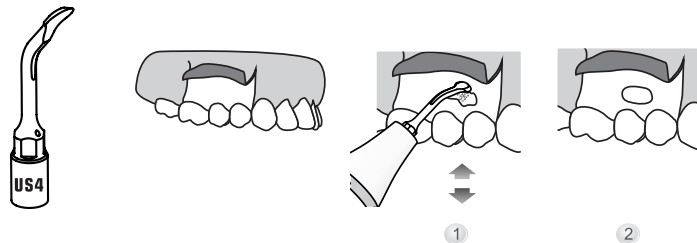

MODE: BONE

POWER:

Quality 1, Quality 2, Quality 3
(Cortical/Spongious)



US5

High efficiency bone osteoplasty: bone remodelling and harvesting of bone chips

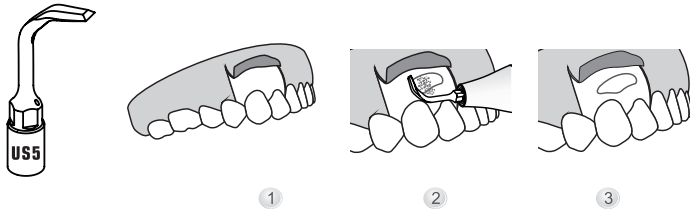

MODE: BONE

POWER:

Quality 1, Quality 2, Quality 3
(Cortical/Spongious)

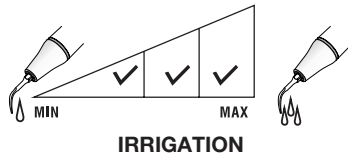

US6

Osteotomy: osteotome of great precision in anatomically thin structures (ridge expansion, corticotomy technique).

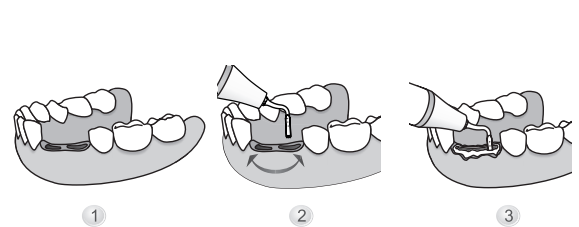

MODE: BONE

POWER: Special

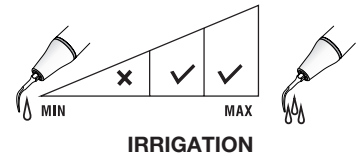

US13

For osteotomy and the removal of apex in posterior teeth area.

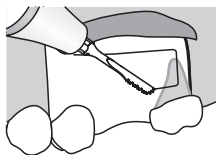

MODE: BONE
POWER: Special

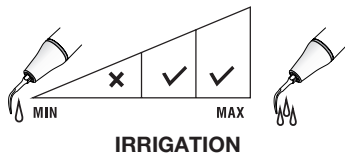

US21

Used for bone cutting. Fan-shaped serration, more convenient for cutting in different angle.

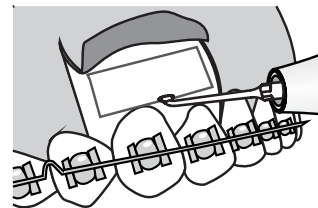
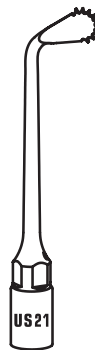

MODE: BONE
POWER: Special

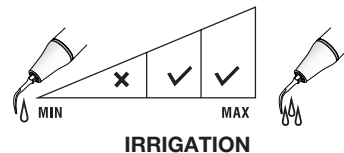

US25

Used for bone surgery.

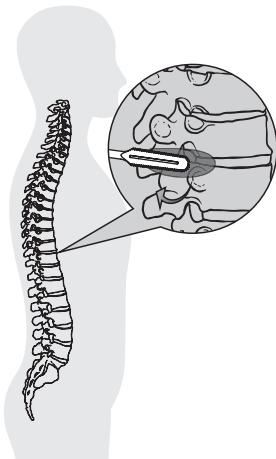

MODE: BONE
POWER: Special

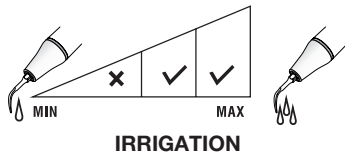

UL1

Tip angle 120°, separation of the sinus membrane in internal zones, non-cutting elevator of the sinus membrane.



1



2

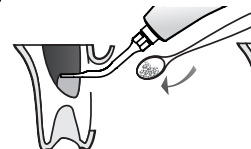

3



4

MODE: ROOT
POWER:
Endo (Maximum power permitted)

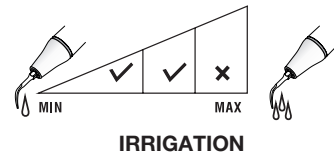

UL2

Schneiderian membrane separation from bony walls: separation of the sinus membrane.

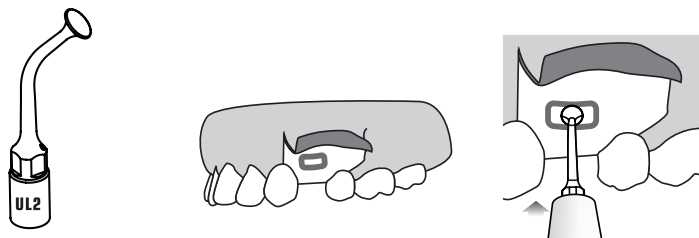

MODE: ROOT

POWER:

Endo (Maximum power permitted)

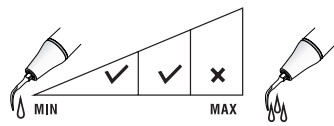

IRRIGATION

UL3

Diamond-coated(100µm) instrument for micrometric osteotomy or osteoplasty: non-traumatic, to finalize the osteotomy or osteoplasty on thin bone and/or near delicate anatomic structures.

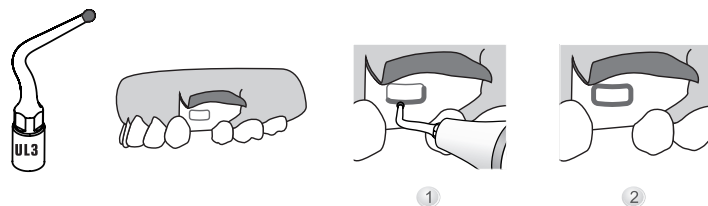

MODE: BONE

POWER:

Quality 1, Quality 2, Quality 3
(Cortical/Spongious)

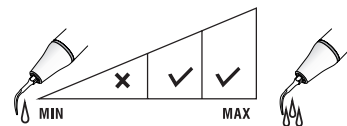

IRRIGATION

UL4

Diamond-coated(100μm) instrument for micrometric osteotomy: to finalize the osteotomy in proximity of soft tissue (sinus membrane, vessel, alveolar nerve).

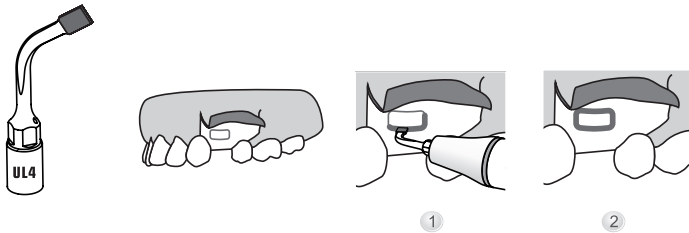

MODE: BONE

POWER:

Quality 1, Quality 2, Quality 3
(Cortical/Spongious)

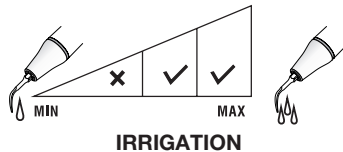

UL5

Tip angle 95°, separation of the sinus membrane in internal zones, non-cutting elevator of the sinus membrane.

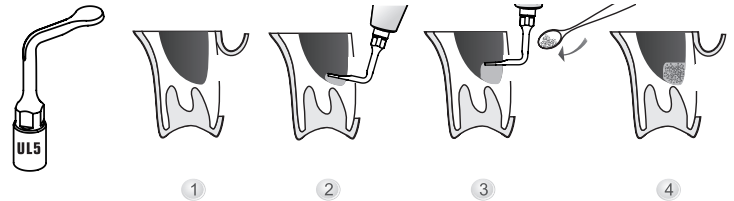

MODE: ROOT

POWER:

Endo (Maximum power permitted)

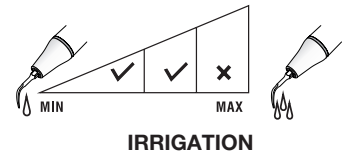

UL6

The head is Ø3mm in diameter and equipped with four water outlets for better separation of the maxillary sinus periosteum. The diamond-coated portion allows for trimming of the edges of the bone window.

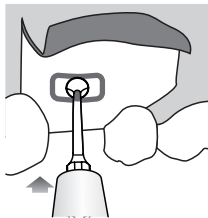
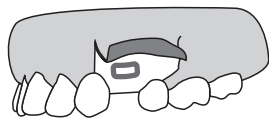
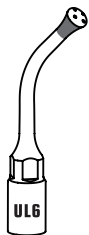

MODE: BONE

POWER:

Quality 1, Quality 2, Quality 3
(Cortical/Spongious)

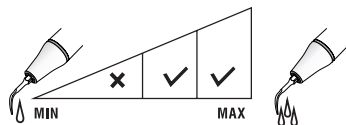

IRRIGATION

UL7

The head is Ø4.5mm in diameter and equipped with four water outlets for better separation of the maxillary sinus periosteum. The diamond-coated portion allows for trimming of the edges of the bone window.

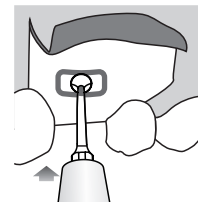
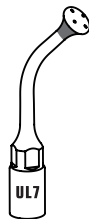

MODE: BONE

POWER:

Quality 1, Quality 2, Quality 3
(Cortical/Spongious)

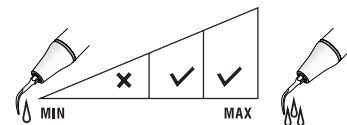

IRRIGATION

UL8

Diamond-coated head (100µm), used for non-traumatic osteotomy and osteoplasty near soft tissue and thin bone region.

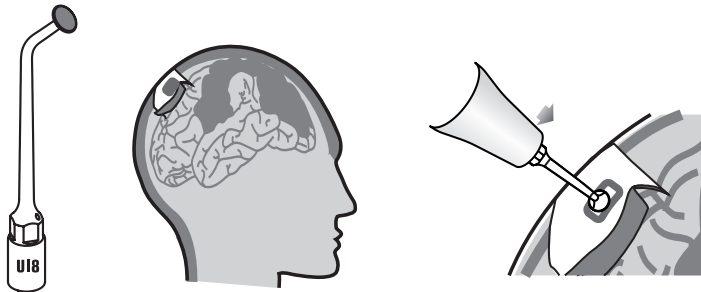

MODE: ROOT

POWER:

Endo (Maximum power permitted)

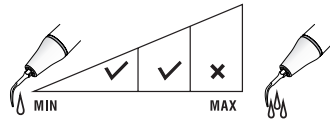

IRRIGATION

UE1

Diamond-coated(40µm) instrument for apical root debridement: diamond-coated instrument for efficient root planning. The length of the diamond-coated on tip is (3.3mm).

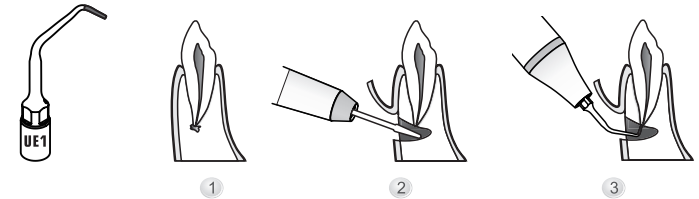

MODE: ROOT

POWER:

Endo (Maximum power permitted)

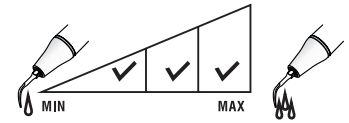

IRRIGATION

UE2

Used for gentle canal cleaning. The length of tip slender smooth part is (4.5mm).

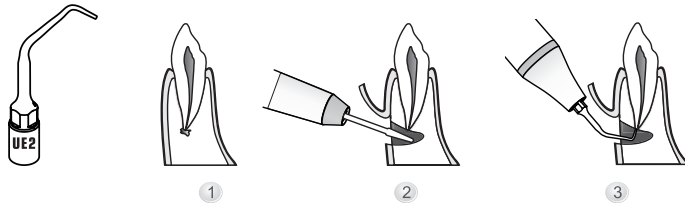

MODE: ROOT

POWER:

Endo (Maximum power permitted)

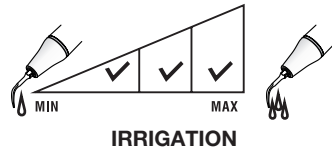

UE3

Diamond-coated(40µm) instrument for apical root debridement: diamond-coated instrument for efficient root planning. The length of the diamond-coated on tip is (2.2mm).

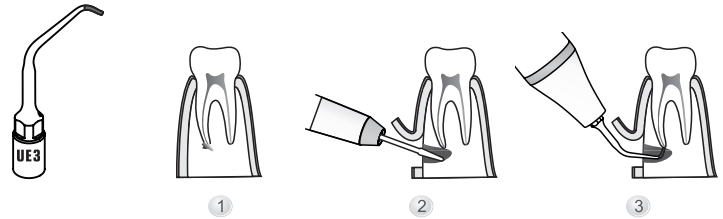

MODE: ROOT

POWER:

Endo (Maximum power permitted)



UE4

Used for gentle canal cleaning. The length of tip slender smooth part is (3.5mm).

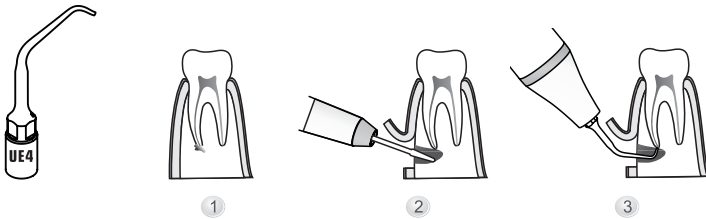

UC1

Used to cut off the ankylosis and root fraction techniques.

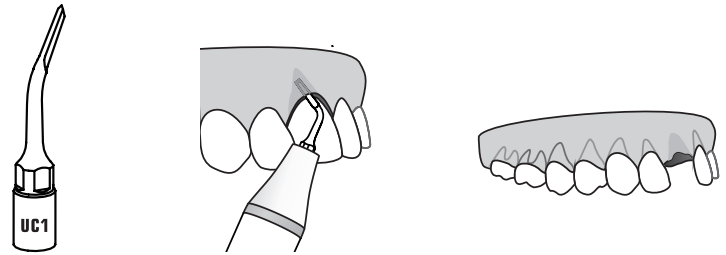

MODE: ROOT

POWER:

Endo (Maximum power permitted)

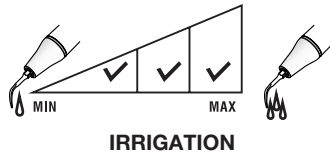

MODE: BONE

POWER:

Quality 1, Quality 2, Quality 3
(Cortical/Spongius)

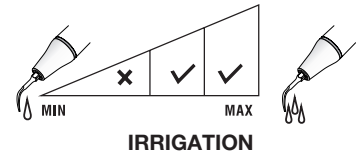

UC2

Left curved, Used to cut off the ankylosis, root fraction techniques in the posterior regions.

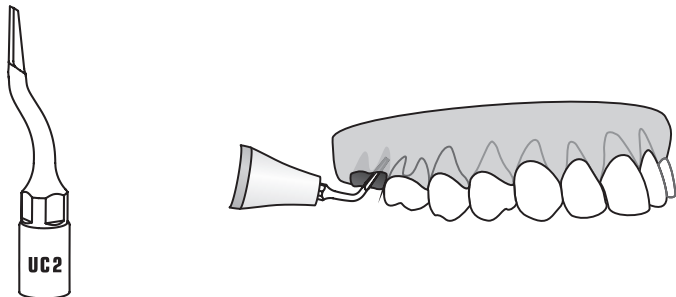

MODE: BONE

POWER:

Quality 1, Quality 2, Quality 3
(Cortical/Spongius)

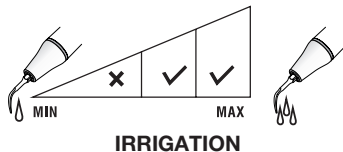

UC3

Right curved, Used to cut off the ankylosis, root fraction techniques in the posterior regions.

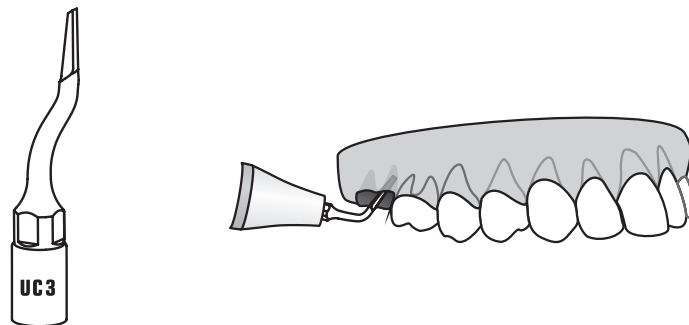

MODE: BONE

POWER:

Quality 1, Quality 2, Quality 3
(Cortical/Spongius)

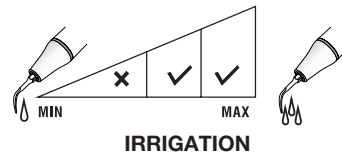

UC5

It is used for minimally invasive cutting of ligaments and tooth extractions, and is especially suitable for extraction of wisdom teeth with oblique angles.

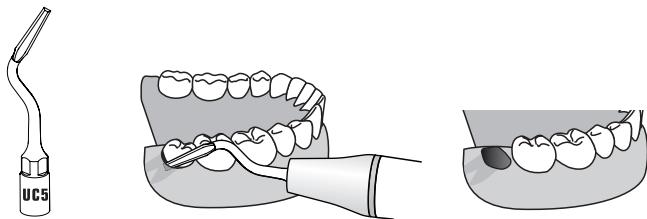

UC6

For teeth extraction and alveolar bone splitting.

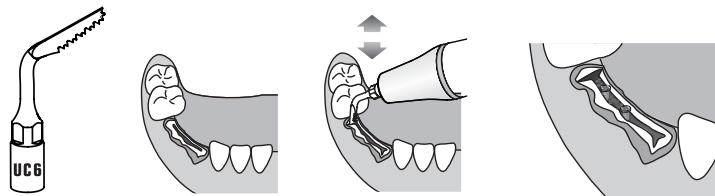

MODE: BONE

POWER:

Quality 1, Quality 2, Quality 3
(Cortical/Spongius)

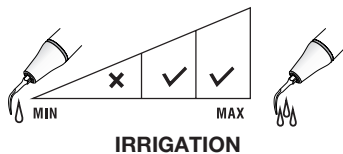

MODE: BONE

POWER:

Quality 1, Quality 2, Quality 3
(Cortical/Spongius)

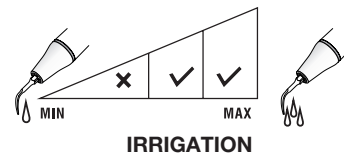

UC7

For teeth extraction and alveolar bone splitting.

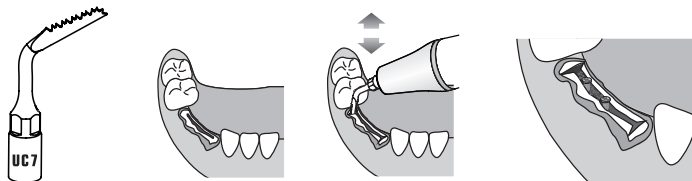

MODE: BONE

POWER:

Quality 1, Quality 2, Quality 3
(Cortical/Spongious)

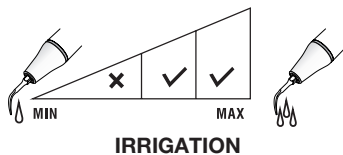

UC8

It is used for minimally invasive cutting of ligaments and tooth extractions, with a very sharp and pointed tip extremity.

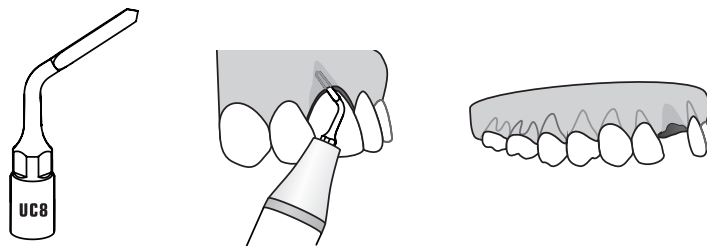

MODE: BONE

POWER:

Quality 1, Quality 2, Quality 3
(Cortical/Spongious)

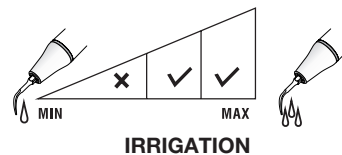

UI1

Ø1.6mm implantation site preparation insert. The working length of the tip is (9mm).

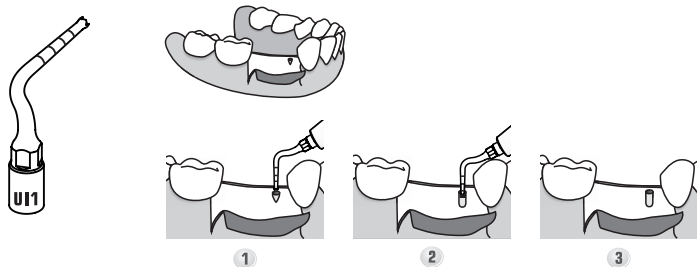

UI2

Ø2mm implantation site preparation insert. The hole at the center of the top for water spray maximum reduce the heat.

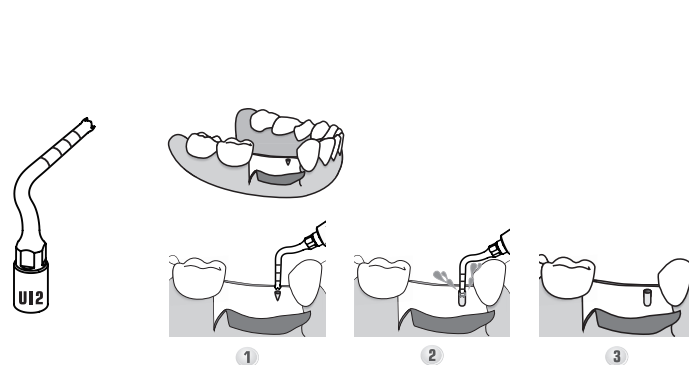

MODE: BONE

POWER:

Quality 1, Quality 2, Quality 3
(Cortical/Spongious)

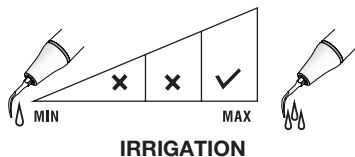

MODE: BONE

POWER:

Quality 1, Quality 2, Quality 3
(Cortical/Spongious)

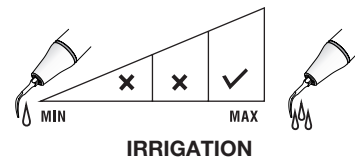

UI3

Ø2mm implant preparation tip used in the anterior tooth area, with sharp tip extremity and water out from the center.

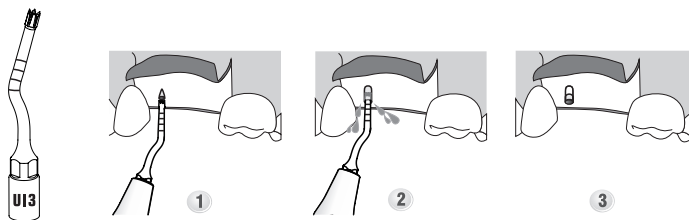

UI4

Ø3mm implant preparation tip used in the anterior tooth area, with sharp tip extremity and water out from the center.

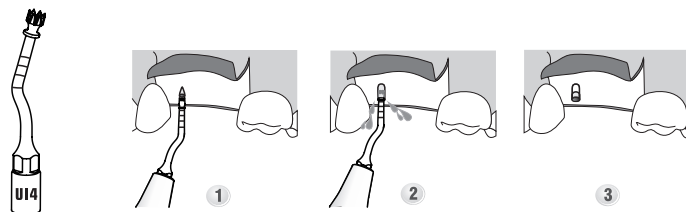

MODE: BONE

POWER:

Quality 1, Quality 2, Quality 3
(Cortical/Spongious)

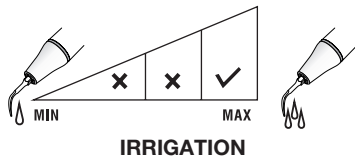

MODE: BONE

POWER:

Quality 1, Quality 2, Quality 3
(Cortical/Spongious)

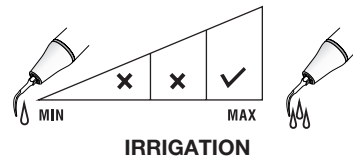

UI5

Ø2mm implant preparation tip used in the posterior tooth area, with sharp tip extremity and water out from the center.

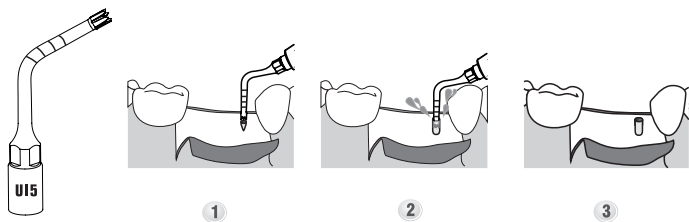

MODE: BONE

POWER:

Quality 1, Quality 2, Quality 3
(Cortical/Spongiuous)

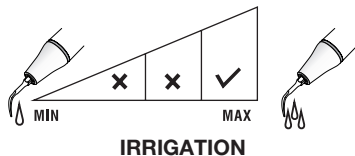

UI6

Ø3mm implant preparation tip used in the posterior tooth area, with sharp tip extremity and water out from the center.

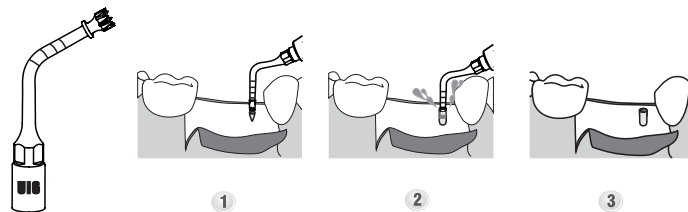

MODE: BONE

POWER:

Quality 1, Quality 2, Quality 3
(Cortical/Spongiuous)

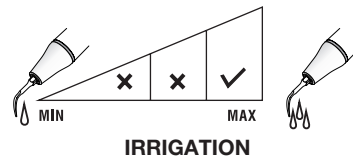

UI7

Diamond-coated(85µm) instrument for finalizing the implantation site preparation close to the alveolar nerve.

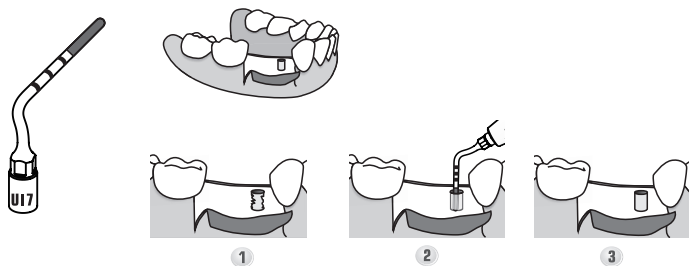

MODE: BONE

POWER:

Quality 1, Quality 2, Quality 3
(Cortical/Spongius)

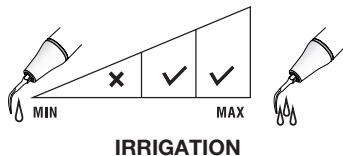

UI8

Ø1.6mm implantation site preparation insert. The working length of the tip is (15mm).

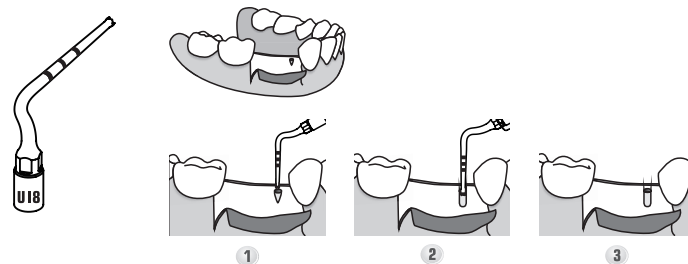

MODE: BONE

POWER:

Quality 1, Quality 2, Quality 3
(Cortical/Spongius)

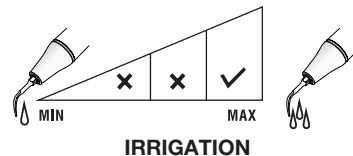

UI9

Ø2.8mm implantation site preparation insert . The hole at the center of the top for water spray maximum reduce the heat.

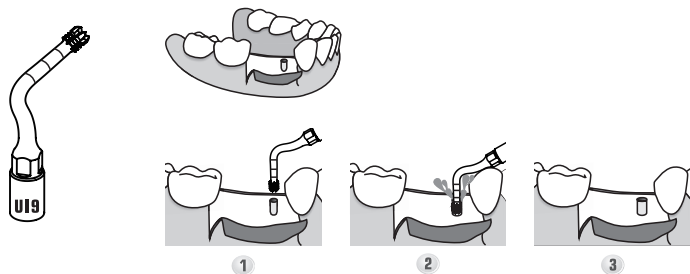

MODE: BONE

POWER:

Quality 1, Quality 2, Quality 3
(Cortical/Spongious)

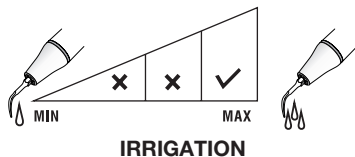

UP1

Recommended for periodontal gentle curetting scaling.

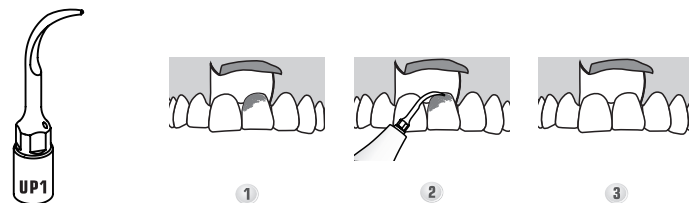

MODE: ROOT

POWER: PERIO

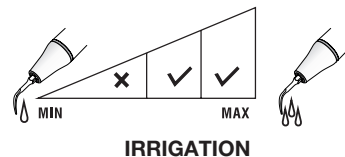

UP2

Inflammatory tissue removal and fractured root apex extraction

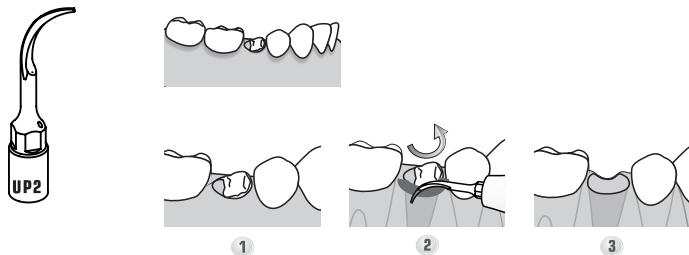

MODE: ROOT
POWER: PERIO

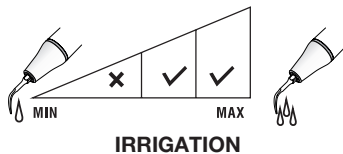

UP3

Recommended for angled periodontal gentle curetting scaling.

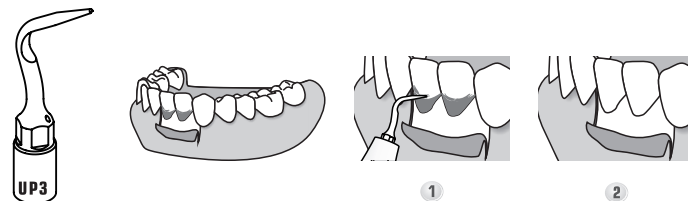

MODE: ROOT
POWER: PERIO

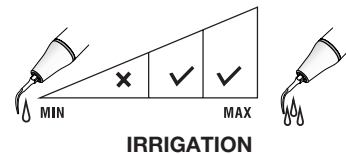

UP4

Diamond-coated(40µm) instrument for root debridement and root planning.

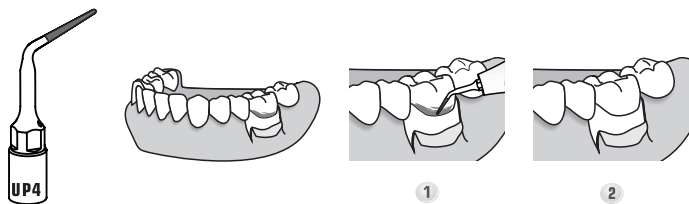

UP5

Recommended for root surface micro-smoothing.

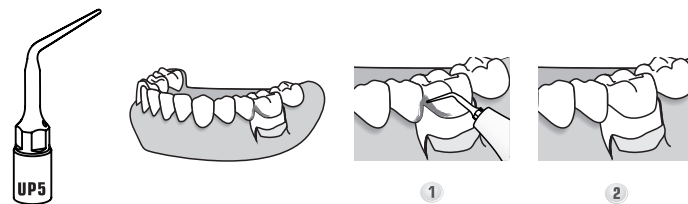

MODE: ROOT
POWER: PERIO

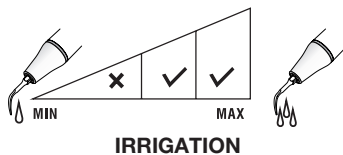

MODE: ROOT
POWER: PERIO

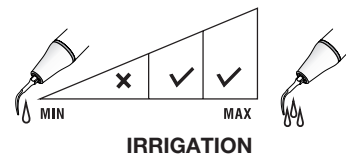

UP6

Diamond-coated(40µm) instrument for micro-osteoplasty: interproximal osteoplasty and root planning.

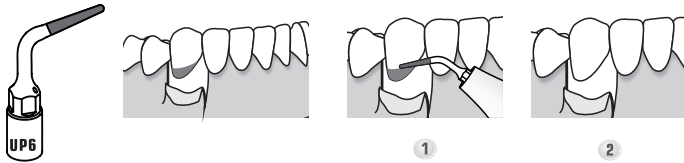

MODE: ROOT

POWER:

Quality 1, Quality 2, Quality 3
(Cortical/Spongious)

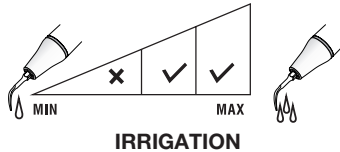

UP7

Diamond-coated(40µm) instrument for root canal orientation and removal of the calcifications located at the 1/3 part of root canal, it can also be used for micro-osteoplasty.

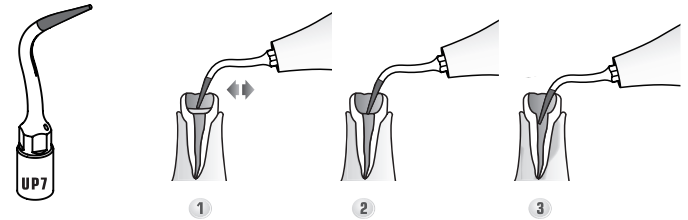

MODE: ROOT

POWER:

Endo (Maximum power permitted)

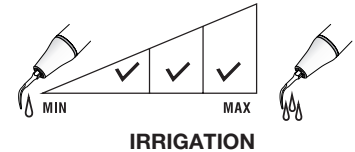

Attached list: Other tips

	Tip Model	Compatible Brand
Scaling	GS1/GS2/GS3/GS4/GS5/GS6/GS7/GS8	Compatible with Sirona Scalers
Periodontics	PS1/PS3/PS3D/PS4	
Endodontics	ES1/ES2/ES3/ES3D/ES4/ES4D/ES5/ES5D/ PS4D/ES8/ES10/ES10D/ES11/ES11D/ES14/ ES15	
Scaling	GK1/GK2/GK3/GK4/GK5/GK6/GK7/GK11/GK20/ GK21/GK60/GK61/GK62	Compatible with Kavo Scalers
Endodontics	EK8	
Scaling	GC1/GC2	
Periodontics	PC1/ PC61/PC61/PC62	Compatible with Amdent Scalers
Scaling	A1/A2	



www.glwoodpecker.com



Guilin Woodpecker Medical Instrument Co., Ltd.
Information Industrial Park, Guilin National High-Tech
Zone, Guilin, Guangxi, 541004 P. R. China
Sales Dept.: +86-773-5873196
[Http://www.glwoodpecker.com](http://www.glwoodpecker.com)
E-mail: woodpecker@glwoodpecker.com



MedNet EC-Rep GmbH
Borkstrasse 10 · 48163 Muenster · Germany

ZMN-SM-003 1.8-20220316